

NADIA AMOPOGA

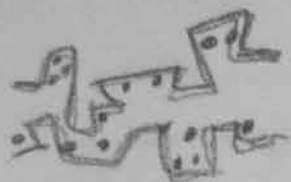

URBAN



RURAL

examples he utilizes refer to the findings of Robert Leach

ENERGY
 • Bronx River
 • pastoral West Egg
 • East Egg

MATTER

INFORMATION

how it changes the cultural landscape of ownership



INFORMATION

options for post peak oil production

(Big Box)

SCENARIO 1 (global economy, global ownership)

SCENARIO 2: (global markets)
 (local economy, local ownership)

kalakaua
 SCENARIO 3: (local economy, global ownership)

This article debunks the common notion that an urban environment is not suitable for wildlife to live in. It instead suggests & proves that an urban environment provides & encourages more diverse ~~and~~ species than the pastoral "pretty" landscape.

This article was more complex in language & ideas. The author introduces two spectrums:

- 1) geophysics < energy - Hubbert
- 2) information technology - Wiener

and he correlated how these two concepts, with "matter" as an additional factor create relationships in the physical world.

He then applies these relationships to a world that is post peak-oil production & how

PROJECT IDEAS

we wanted to highlight the efficiency of the city of Vernon by implementing systems that seem familiar.

introduce a new kind of industry to the landscape of Vernon that we like to call a "growing industry"

• Vernon as you know is positioned in very unique circumstances and we have proposed a system that would interplay with the strengths of Vernon (Food Proc. & distribution)

programmatically, we see the massive industry in Vernon as a possibility of producing things ~~in Vernon~~ through low input - high output methods

- aquaponics
- mycostructure
- entomophagy
- ramiculture

ELAC

Nature

- social media affecting the aggregate or socializing
- find connecting hubs for people
- proposed recreational - outside hubs along LA River
- temporary housing (Capitol hotel)
- provide recreational amenities for visitors

John

- the city cell

→ making relationships between the spaces within Vernon

□ induce a sense of community

residential spaces

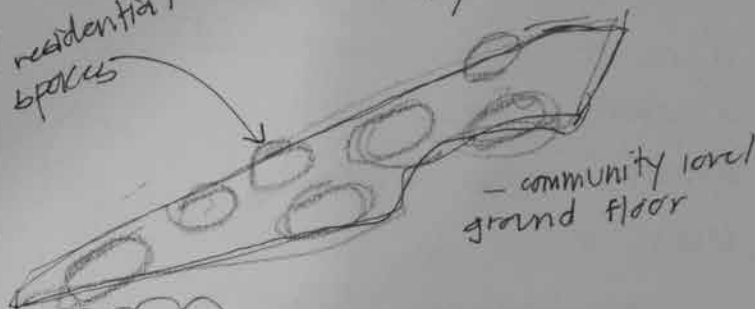

Salahi

density → makes integration
prox.

- * expandable units
- * bringing unique dynamics to individual housing
- * flex-housing

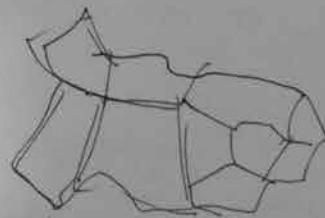

PERIODIC SOIL REMEDIATION

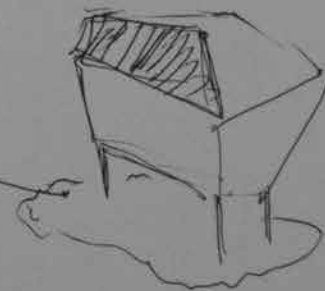

LAND 360 MEETING

- becoming a sponge, team player
- outreach => urban land institute
- orange, community that evolved on it's own

HOT DOG THEORY

GROUP MEETING 1/22/2014

take what's bad and turn it into a positive perspective

GLARING ISSUES

pollution

waste HABITAT ENERGY LANDFILL

* FOOD DEPENDENCE

* BIOMIMICRY

MYCOTECHTURE <-> mycorrhizal symbiosis

ISSUES WE CAN SOLVE

- waste
- pollution
- habitat
- production

* WEDNESDAY

two visitations with ELAC

3rd -> VERNON (meeting for the chamber of commerce) business owners in Vernon

FRAMEWORK FOR INTERVENTION

cradle -> cradle not cradle to grave
programmatics
aquaponics
* mycotechture

AIR NOISE

FRIDAY - GWA

generating ideas about urban systems (quickly)

printed base material

-> aerial photos

-> parcel

BRING DIGITAL CAMERA

2-4 minute check-in status

DON'T BE LATE!

MAPPING

remember this is a

250 words shared resource!!!!

-> 50 per combo

(something that conveys the point of view)

BE KINDA MINIMAL

BUILDING INFRASTRUCTURE nobody wants to do.

FOOTPRINT + HYDROLOGICAL

framework for water capture

could we clean the water for reuse?

POWER

focus ugly stuff

the ones that don't have a place

-> the marketplace

LOW INPUT - HIGH OUTPUT SOURCING at industrial scale

geographic - location
↳ distribution
↳ distance

BUSINESS
UTILITIES
DISTANCE

resources available
to carry out
framework

. waste products
. carbon footprint

location
distribution

the beautiful
ugly opportunities
of vernon

"vernon as a good
neighbor"

THE UGLY → BEAUTIFUL

40,000 DAILY

- . vacancy
- . channelization
- . no population
- . geographic distance

#1-5 framework
6 = programming

*ECONOMY OF PRODUCTION



FOR FRIDAY
lab maps
↳ site scale
↳ regional

there's no place
for industrial
in Los Angeles
↳ PATT VERNON

DISTANCE
LOCATION
HYDROLOGICAL

HPU
UP

FRAMEWORK
ELEMENTS

orange = food
green = wholesale
blue = chemical
burgundy

brown = recycling
tan = retail

- building footprints
- vacancy rates
- abandoned infrastructure
- low input power
- hydrology
- proximity to river
- groundwater ?
- urban watershed
- rooftops
- streets
- river
- pumping stations
- highlight positive population
- DISTRIBUTION (to neighbors)
- perfect distance
- low input HIGH output
- chinese scale = industrial

TOP 20
INDUSTRIES
+ 250 word
expl.



RETROFITTING NEW INTO THE
OLD WAREHOUSING

- o through minor alterations

HOW DOES THE LANDSCAPE
OF VERNON f(x)

INSECTIVISM
AS WORMS, MUSHROOMS, & FISH
-institutional memory of the city
of vernon (industrial)

VALUES + NARRATIVE

WHO, WHAT, WHEN, WHERE, WHY

globally & locally

- o vernon as a future model
old world technique for new world
shortages

"NEW IDEAS & NEW INDUSTRY"

infographic arguments

- o subversive action

ELAC PRESENTATION

50+ more people in the city of

vernon

- o presentation on housing options

TO DO = WED.

o research information for
diagrams

- o PH-11m diagrams

smaller questions?
BIG & SMALL
→ OF MAPS &
MAKING
"IF MICE & MEN"
-Lenny

*SIDWELL

FRIENDS SCHOOL

→ closed loop
system of
water recycling

MACRODIGESTIVE
STRATEGIES

*NATURATIC

FOR
FRIDAY

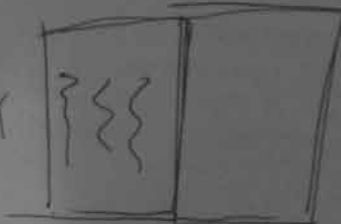

*BRING CAMERA

*DIGITAL PRES.

TV CHAMBER OF
COMMERCE

WRITTEN: current systems,
future projections
& possibilities

DIAGRAMMATIC: global implications
local implications

open system → liner
choose area in which there's groundwater

SERIAL # 900-44228795
key = 777F1

AUTOCAD
registration

"in every relationship,
the person that cares least
always has the power."

~~the water table~~
depth

depth
level

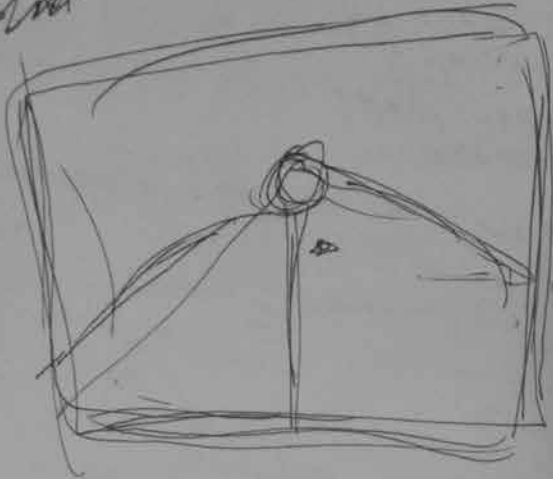

□ rail, combination, GIS
city of Vernon
Andy's, adjust to
fit

- WHERE SHOULD TRANSPORT GOODS
LINE BE APPROPRIATED?
- HOW ARE METRO-LINES / STOPS
DESIGNATED? FOR BEST
MAXIMIZATION

The Attachment Principle

The Breakup cure

1. Break the attachment,
focus on being happy on your
own

→ outer shell

→ inner core

opening More

→ rejection reversal method

The Power Shifter

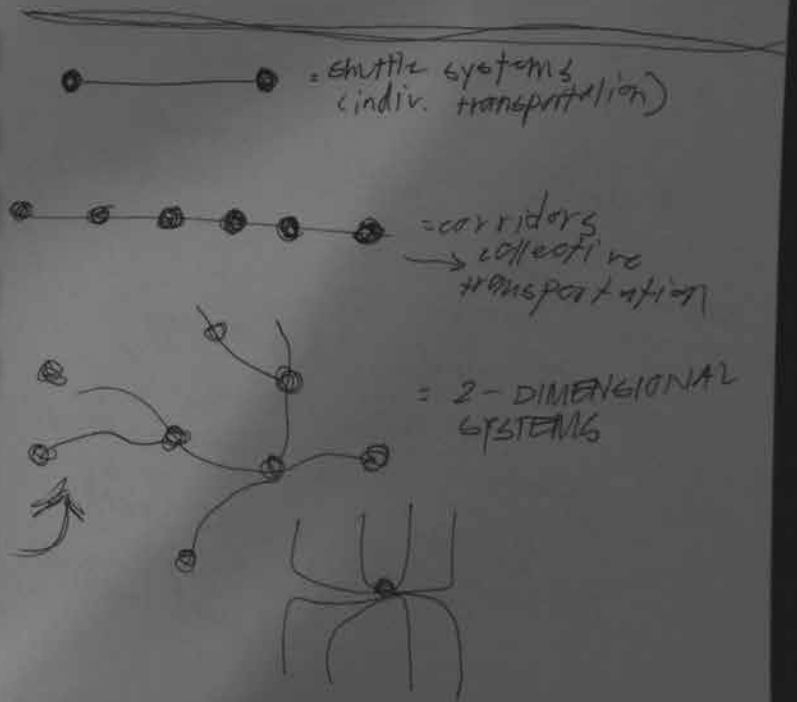

THE MOVER REND. MATCH PROGRAM

This station is intended to ***GUTS** signify the point of convergence of intermodal Plurals within the city of Vernon as well as promote opportunity of camaraderie amongst Vernon streetcar ridership & cargo bike workforce ***only talk about WEAVE**

The central threads featured on site a water in form of

- resource of amenities such as cargo bike wash & showers

- food - urban ag by products
- mycorrhizal remediation
 - algaculture tubes

- circulation portrayed through
- cargo bike
 - streetcar } for the transport of goods & people

forced repositioning of arch. lines informed the delineation of space layers

This diagram conveys the process in which the site is designed upon arch. insp. derive from force lines & the strong triangular formation that make up structural frame of cargo bike

→ other layers are the cargo bike people & streetcar circulation informed by abandoned rail infra.

***softness in juxtaposition of**
This is an perspective of ***hardness** illustrating an aerial view of the station & citizens ***DATA** → within it ***illustrate** production benefit

***financially viable** → **local & more efficient** → ***figure ground** existing conditions

houses. co-ops } choose model building for retrofit the typologies

- streetcar dist. mainly people, but ***change** can retrofit to accommodate surplus in the amount to fit reg. dist.

- streetcar 1 route, fit 2 cats

***reiterate why vernon is positioned**
***benefit incentives**

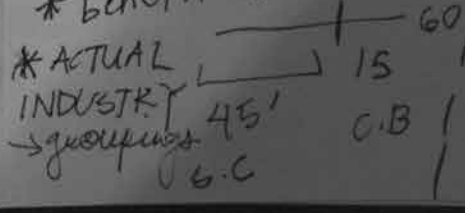

***THE WHY**
***interconnect**
***nested & div. of river**

TODAY

transit
FINAL

□ diagrams
□ sections

CARGO
BIKE
FORM



PERSPECTIVE
FRAME

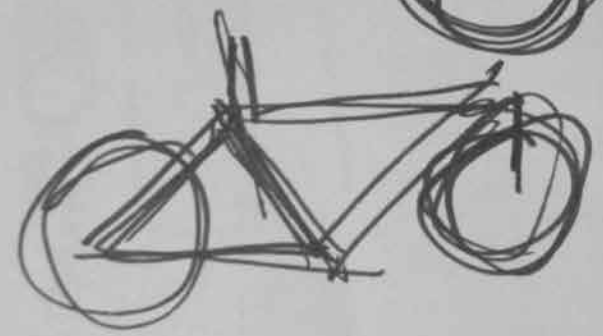
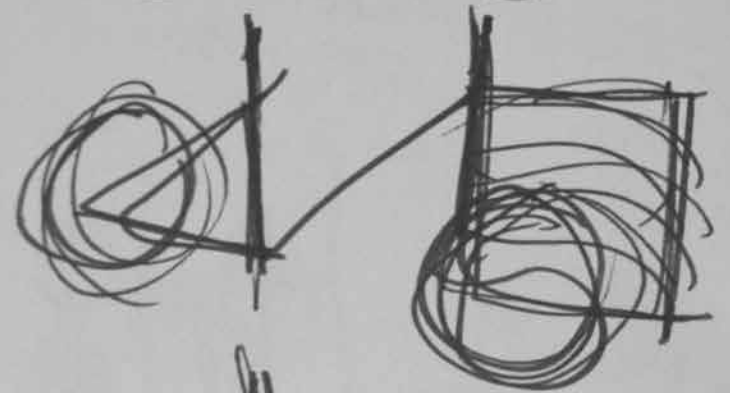

forms

• TRIANGLES

• SPOT WHEEL

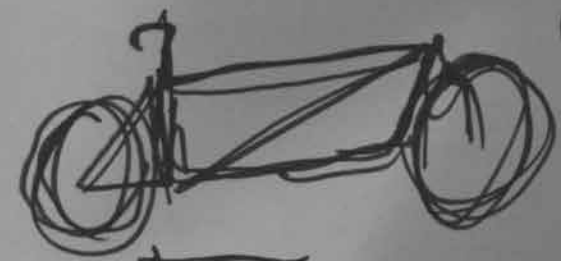

SECTION



FLOOR PLAN

* FOCUS ON FOOD, WATER, CIRCULATION

* OVERLAP

is there a growing product, maybe?

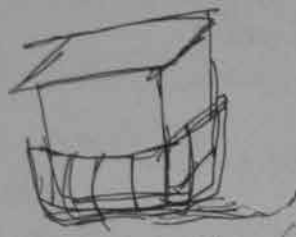

- storage (bike)
- parking bays
- repair - mapping
- * propose to connect to the civic center
- * on grand citations

→ FOOD AT THE HUB

* BLATT LINES



→ brief

- DEVELOP PHYSICAL DESIGN LANGUAGE

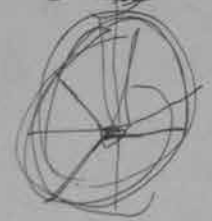

→ plate

INDIVIDUAL

- ✓ research
- ✓ cargo bike construction
- ✓ THE HUB

FORM

- Final drawing
- AUTOCAD 3D
- Plan + sketchup (PRINT 24x36)
- ✓ (half) AUTOCAD
- areas of interest (PLAN & SECTIONS)

(in paper)

- ✓ finish edits to FINAL FORM + diagrams

- DIAGRAMS rough in illustrator (work on now)

- * PROPOX JEREMY THE GROUP STUFF + PRELIM DESIGN STUFF
- DRAW → COLOR PLAN

* AUTOCAD BASE PLAN

* DIAGRAMS 1/2 & renderings 1/2

- * SECTIONS * DO sections in illustrator
- * SKETCH OUT THE HUB

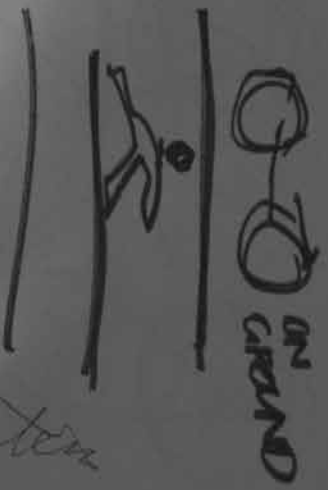

→ plates

#1



PAPER SPACE

collectively 4 or 5 happenings overlapping & reference the substructure!!!

INDIVIDUAL CONCEPT

The intervention transit system combines both a streetcar system and a cargo bike system for the distribution of goods. This type of system coincides with the low input - high output framework as delineated within the previous framework.

within the intervention transit system there is a central HUB that is the point of convergence for the multi-modal transit system.

This is where ~~bikes~~ bicyclists, with leisure and worker can expect amenities for both themselves and their likes. Featured is also a pedestrian bridge that provides access without disrupting the freight & streetcar distribution flow.

Across the bridge is the G³, the streetcar service station. This is where the streetcars receive maintenance and the operators can enjoy amenities ^{as well}

CONCEPT (objective) ^{business to business}

To provide a transit system for the distribution of goods and people throughout intervention.

→ The blue lines are streetcar ^{route} loops and is routed around the perimeter of industry

→ The dashed lines are the bicycle routes for cargo bikes to infiltrate the alleyways of industry for ^{route} faster ^{route} impact - high frequency distribution

→ The stations are located at major points within the site and serve as a streetcar → bicycle connector station

→ The central HUB is located along ~~the~~ Vernon Ave and serves as the connector from the Blue Line to local Vernon (then connects to